

REASSEMBLY

1. INSTALL RELIEF VALVE

Install the relief valve, compression spring, new gasket and plug.

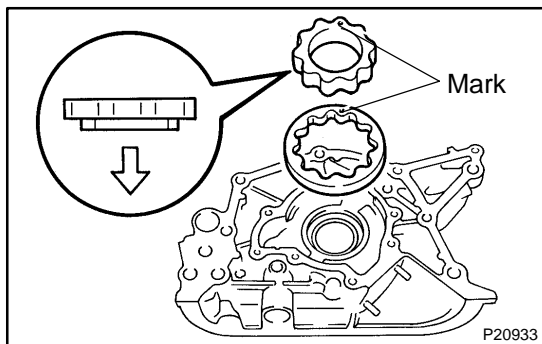

2. INSTALL DRIVEN AND DRIVE ROTORS

(a) Install the drive and driven rotor.

HINT:

Place the drive and driven rotor into pump body with the marks facing the pump body cover side.

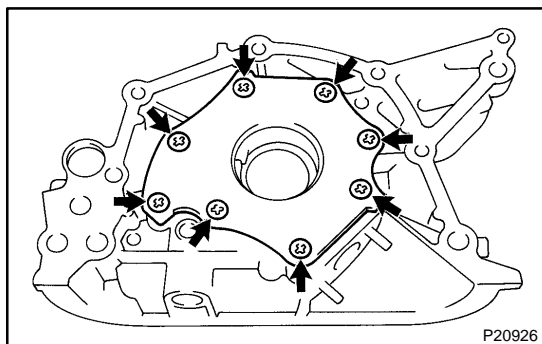

(b) Install the pump body cover with 8 screws

Torque: 10 N·m (105 kgf-cm, 8 ft-lbf)